



ATISLELOK[®]

RIGID CONTAINMENT



4', 5', 6', 7', and 8'
Magnetic Rigid
Swing Doors
Installation Guide



4', 5', 6', 7', and 8' Magnetic Rigid Swing Doors Installation Guide

Before You Begin

We recommend that you familiarize yourself with the contents of this installation guide before beginning the installation process. Doing so will save you a lot of time and effort. Including a review of this guide, it shouldn't take longer than ten minutes to set up the AisleLok® Magnetic Rigid Swing Doors.

The bulk of this document covers tool-less installation on IT cabinets, but there are also sections on mechanical attachment as well as set up using one of our Adjustable Mounting Posts.

Although the AisleLok® Magnetic Rigid Swing Doors are very easy to assemble and can typically be installed in just minutes, please read through these instructions thoroughly for proper installation in your environment. Should you have any installation issues, please refer to the troubleshooting section of this guide on page 13.

Table of Contents

- 1 Installation Tips
- 2 Door Installation
- 8 Transom Window Installation
- 11 Mounting to Return Walls and Other Structures/Components
- 13 Troubleshooting

Installation Tips

GENERAL

While it is possible for a single person to install the Magnetic Rigid Swing Doors, we recommend a two person installation team.

DOOR ALIGNMENT

- There are two types of Swing Door alignment considerations: first is aligning the seam between the doors where they meet, the second is aligning the face of the doors.
- **Seam Between Doors.** Adjustment of the seam between the doors is achieved by adjusting the position of the Door Panel Assembly A and Door Panel Assembly B on the cabinets. (See page 4, Step 2.2, Detail 2).
- **Faces of Doors Not Flush.** This is due to the cabinets not being parallel/plumb. The tops of the doors will always be aligned because they are connected to the header. The alignment of the bottoms of the doors is dependent on how plumb the cabinets are on each side. Use a level and adjust the leveling feet until the cabinets are plumb. This will bring the face of doors into alignment.

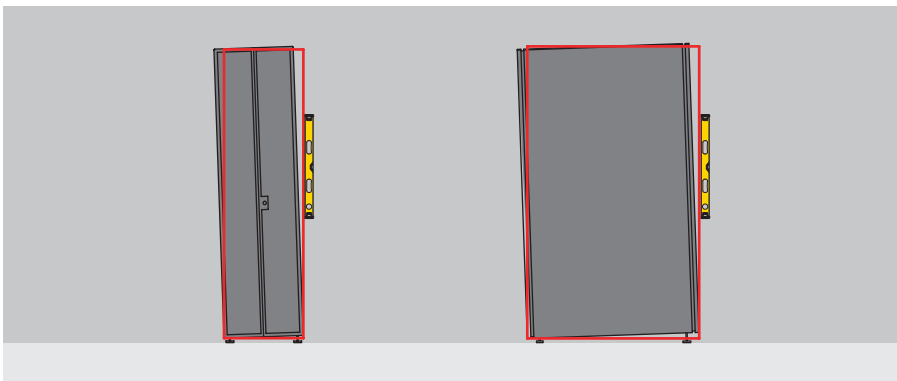

CONNECTING DOOR PANEL ASSEMBLIES TO HEADER OR TRANSOMS

When placing a Header or Transom Assembly on top of the Door Panel Assemblies, it may be helpful to disengage the Magswitches of the Door Panel Assemblies to secure the CamLocks to the Header or Transom Assembly.

TETHERS AND CABLE-LOCKS

To simplify the process of securing the tethers and cable locks it is useful to pre-position the cable lock on the tether. After the tether has been secured to the header with the hammerhead screw and thumb nut, determine the best final position for the cable lock. Adjust the position of the cable lock on the tether so there is no slack between the header and the cable lock. Then thread the loose end of the tether through the desired hole in the top of the cabinet or other secure location and then run the tether through the cable lock and gently remove slack (See page 9, Step 6).

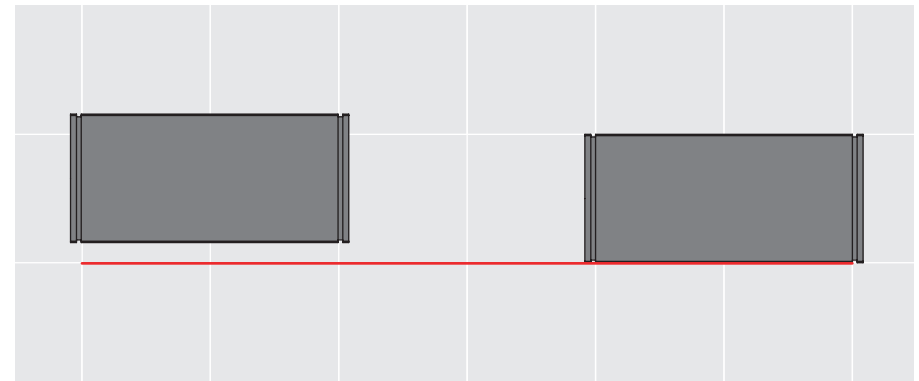

Magnetic Rigid Swing Doors Installation

Included Parts

DOOR PANELS

- A** Door Panel Left x1
- B** Door Panel Right x1

HEADER (OPTION)

- C** Header x1

TRANSOM (OPTION)

- D** Transom x1

TETHER KIT

- E** Tether Cable x2
- F** Hammerhead Screw x2
- G** Thumb Nuts x2
- H** Washer x2

ASSEMBLY TOOLS

- I** Torx Wrench x1
- J** Sandflex Hand Block x1

OPTIONAL COMPONENTS

- K** Door Limiter x2

NOTE: Optional Transom ships in a separate carton.

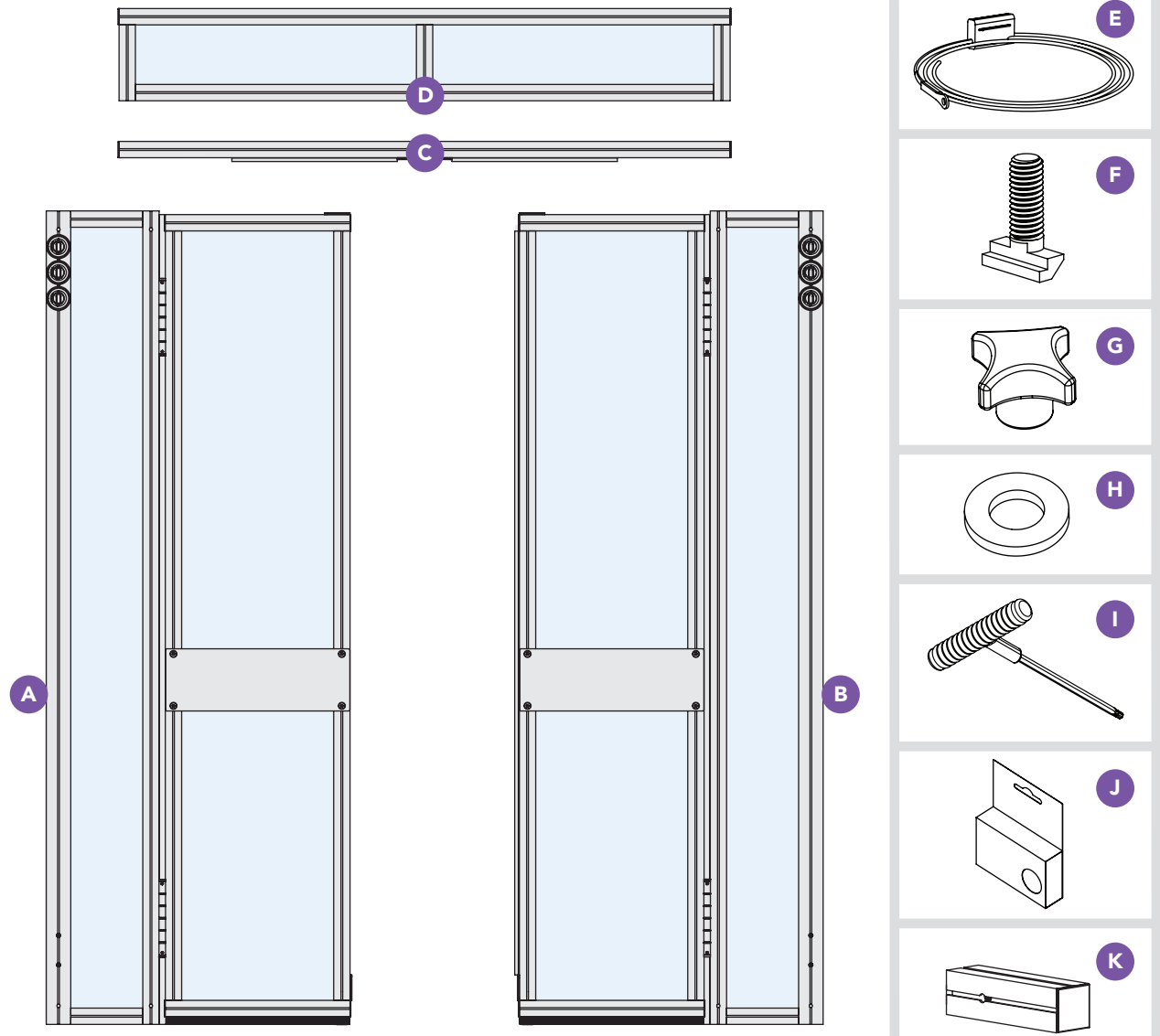

STEP 1

Attach door to the cabinet:

NOTES: Prior to beginning installation, make sure cabinet sides are plumb with each other. The 4ft door is shown. Assembly for the 5ft, 6ft, 7ft, and 8ft doors follows the same procedure.

1.1 Place the base of Door Panel Assembly (A) against the base of the cabinet side, with the inside edge of the Door Panel Assembly aligned with the center of the aisle. (Left Door Panel Assembly (A) is shown, but either can be installed first).

1.2 Tilt the Door Panel Assembly up against the side of the cabinet. The cups magnets at base will attach to the cabinet.

1.3 Turn the Magswitch upward to the locked position (Detail 1). Repeat this process for all three Magswitches. The door panel will hold itself in position.

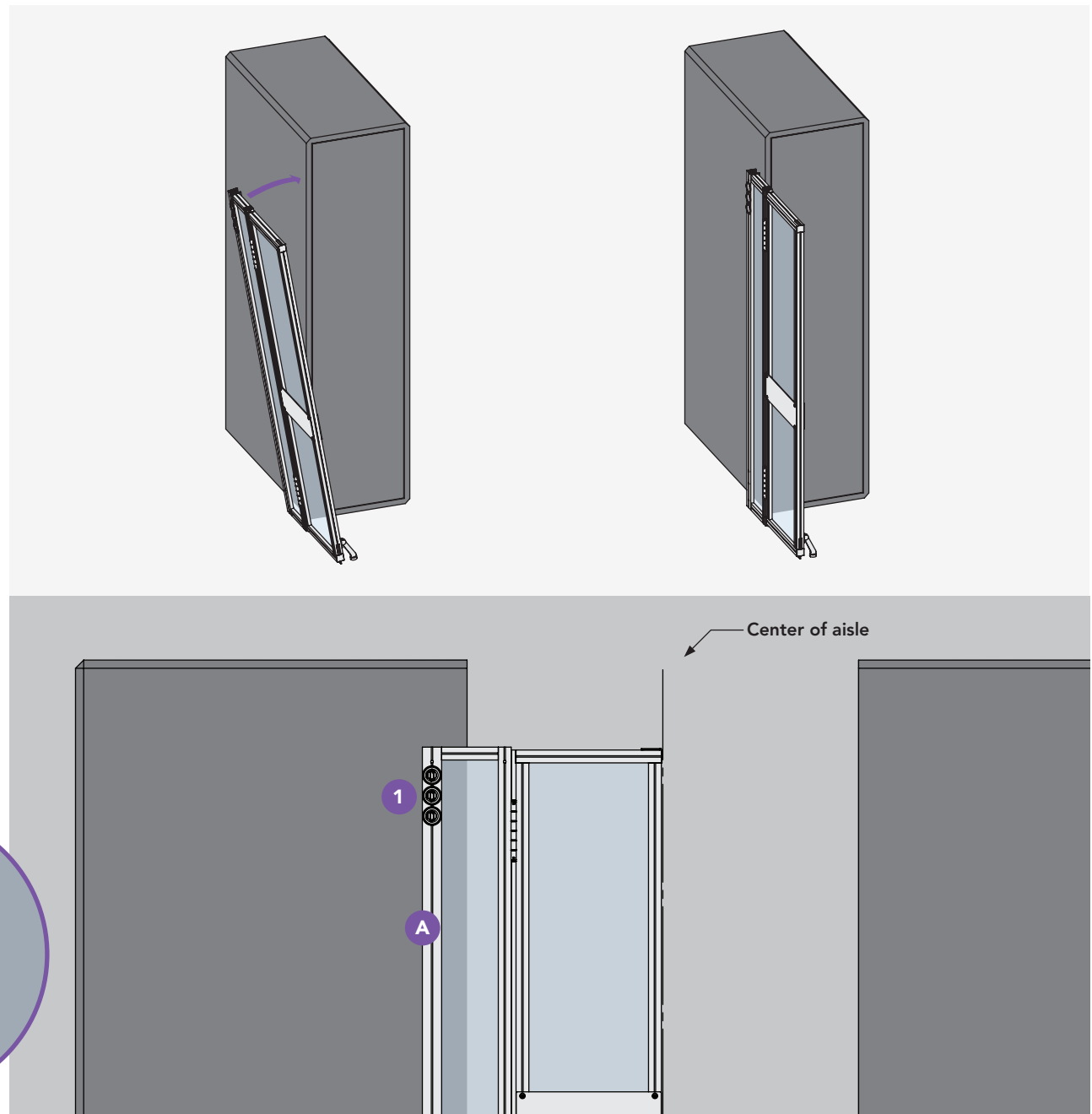
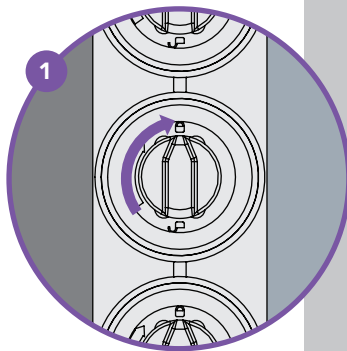

STEP 2

Attach second door to the cabinet:

2.1 Repeat steps 1.1, 1.2, and 1.3 for Door Panel Assembly (B).

2.2 Make any necessary adjustments to align the inside edges of the Door Panel Assemblies. Set the gap between the Door Panel Assembly aluminum frames at approximately 3/8 in (9mm). The seal between the adjacent door panel assemblies should just barely make contact (Detail 2).

2.3 Ensure all Magswitches are engaged in the "Locked" position.

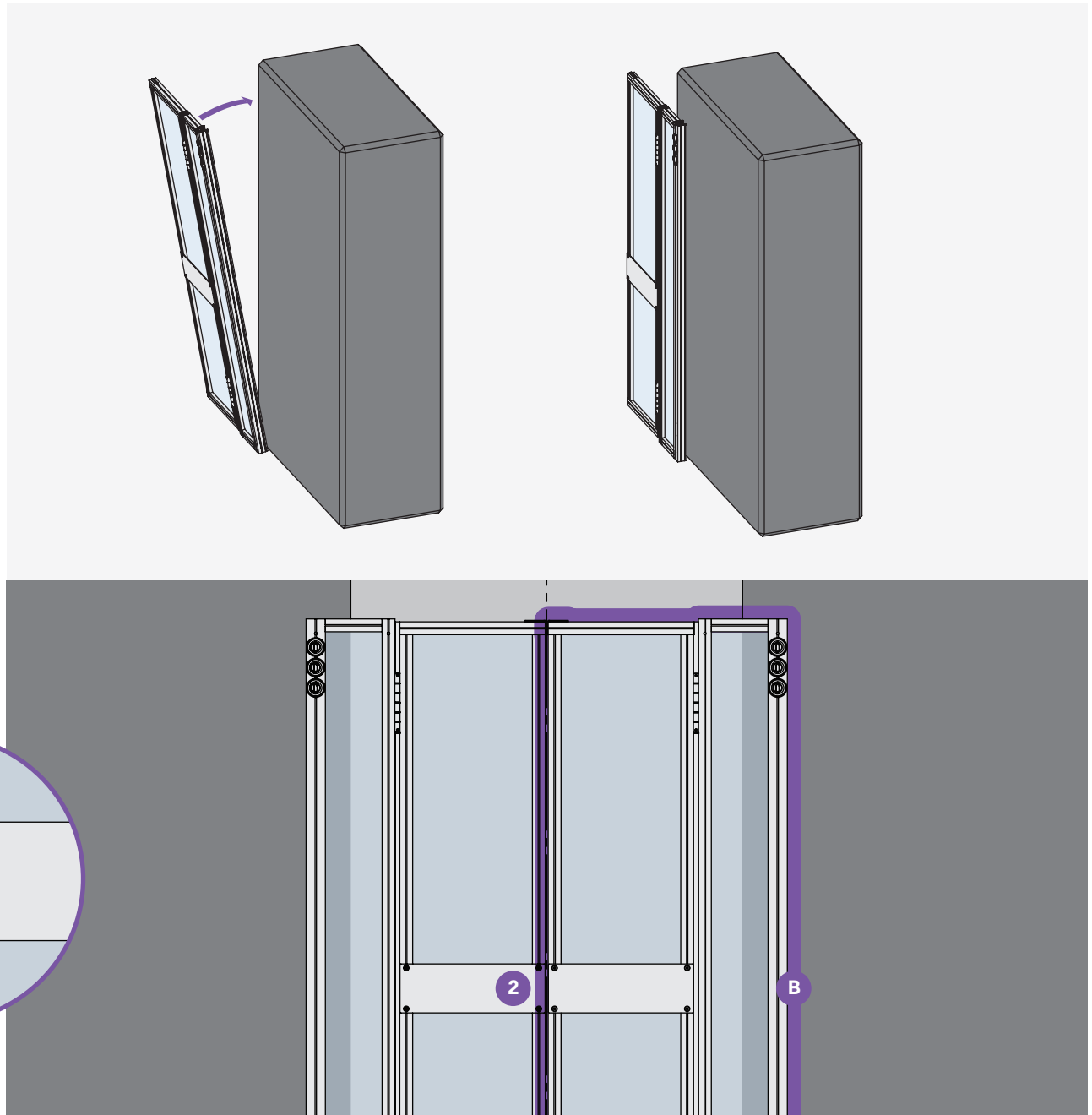

STEP 3

Attach the header:

3.1 Place the header on top of the Door Panel Assemblies with the Header's Magnetic Latches and Seal facing down. Ensure the CamLoks at the top of the sidelights, recess into the system groove along the bottom of the Header.

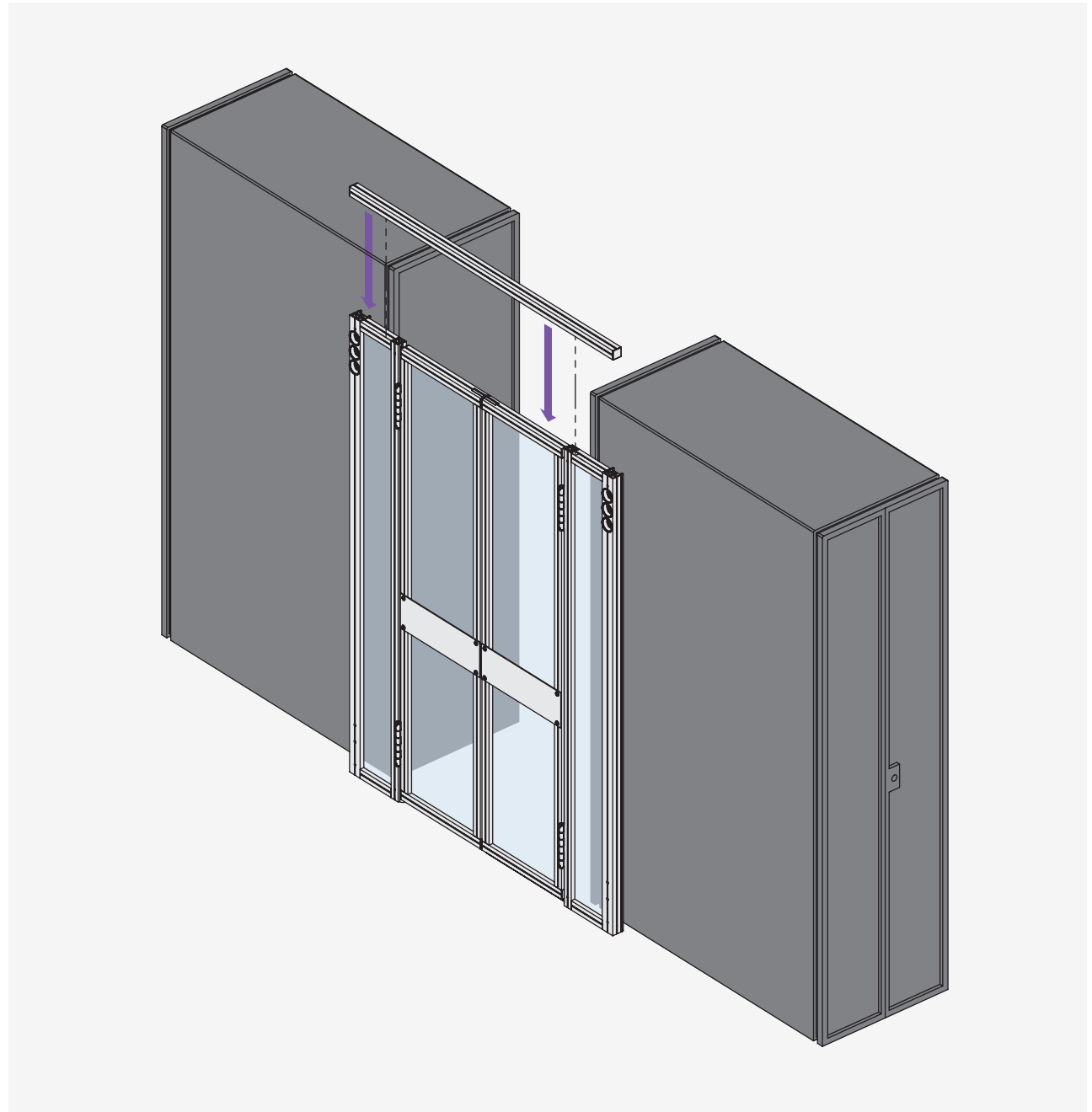

STEP 4

4.1 Align one end of the header extrusion with the corner of the corresponding Door Panel Assembly (Detail 3).

4.2 After Aligning the header on one side, Lock the corresponding CamLoks using the provided Torx wrench. Detail 3 shows proper alignment. The end of the header should sit flush with the corner of the Door Panel Assembly. Note that the End Caps on the Header or Transom protrude beyond the corner of the Door Panel Assemblies. If the left side is aligned first, Lock CamLoks on the left side. If the right side is aligned first, lock CamLoks on the right side.

When tightening CamLoks it is important to rotate the CamLok a full 180 degrees with a Torx wrench. There will be initial resistance, go past the resistance to fully engage the CamLok at 180 degrees.

4.3 Repeat steps 4.1, and 4.2 for the opposite side.

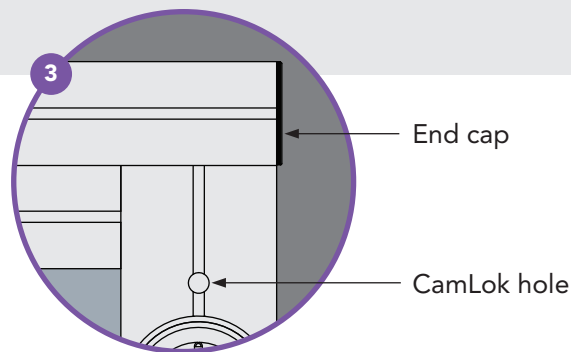
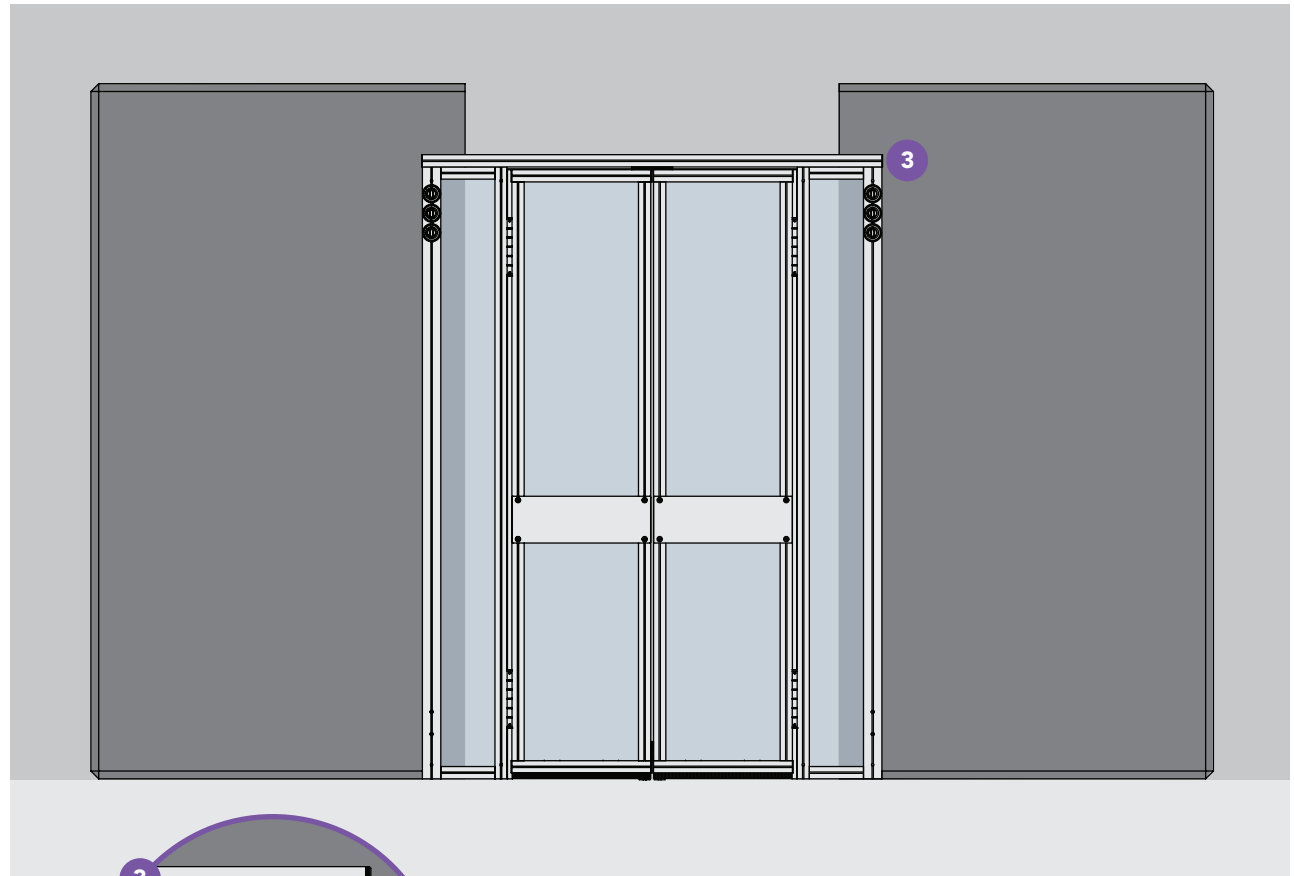

STEP 4

4.4 After aligning and locking in both sides of the Header or Transom the gap between the doors may not be uniform. Move the bottom of the Door Panel Assemblies inward or outward until the gap at the bottom matches the gap at the top (Detail 4 and 5). The magnetic latches at the bottom of the doors should just barely touch. If they overlap too much they will interfere with the proper operations of the doors.

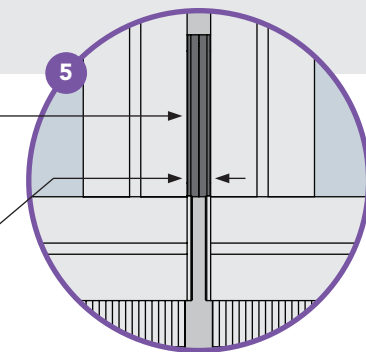
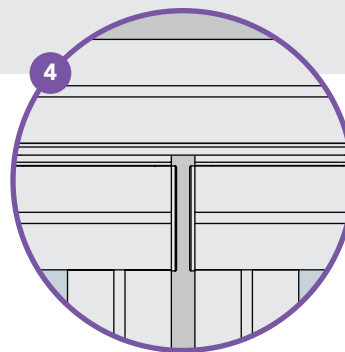
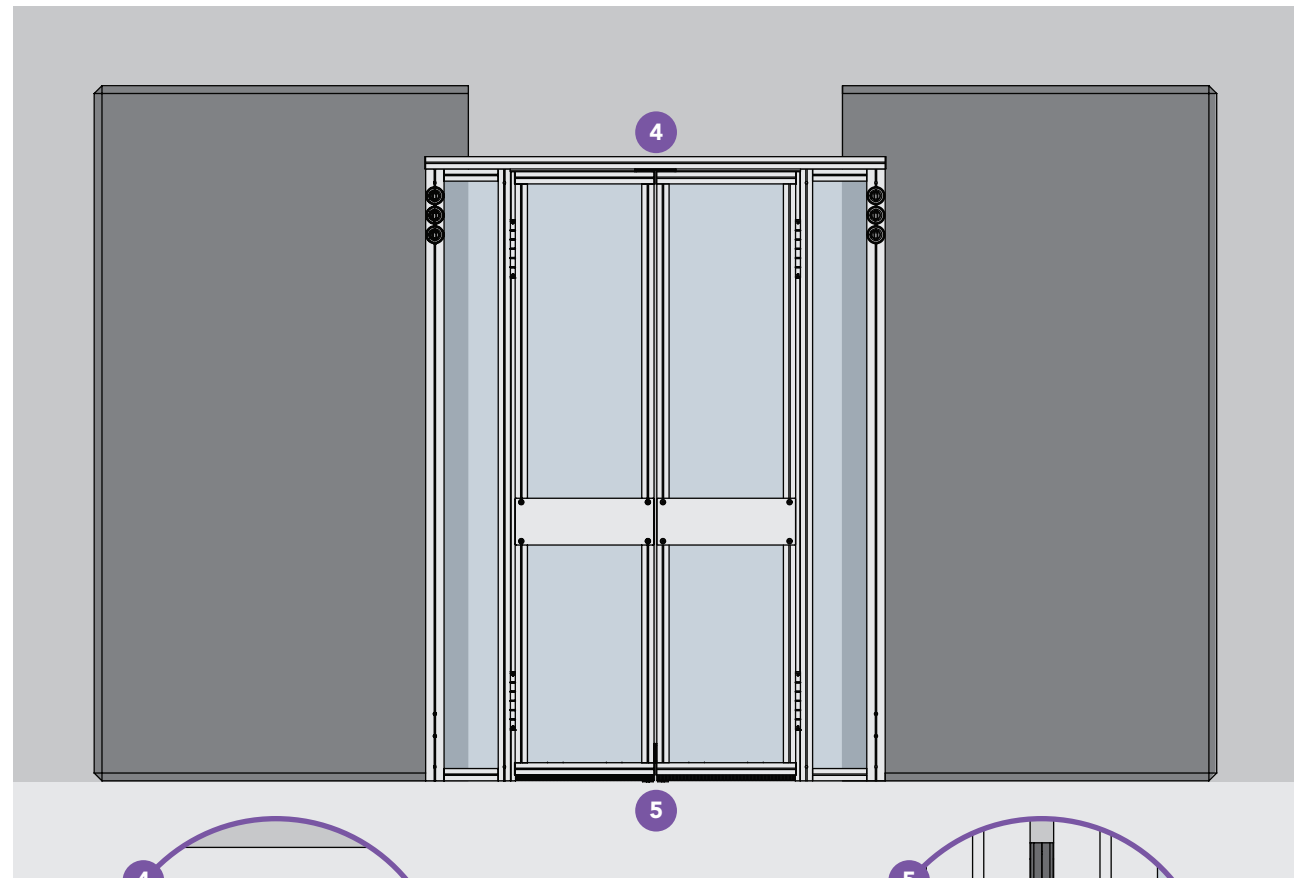

Door gap approx. 3/8in (9mm) → ←

STEP 5 (INSTALLING OPTIONAL TRANSOM)**Attach the transom:**

5.1 Place the transom on top of the Header with the Transom's CamLoks facing down. Ensure the CamLoks in the bottom of the Transom recess into the system groove along the top of the Header.

5.2 Secure the Transom to the Header by tightening the Transom CamLoks.

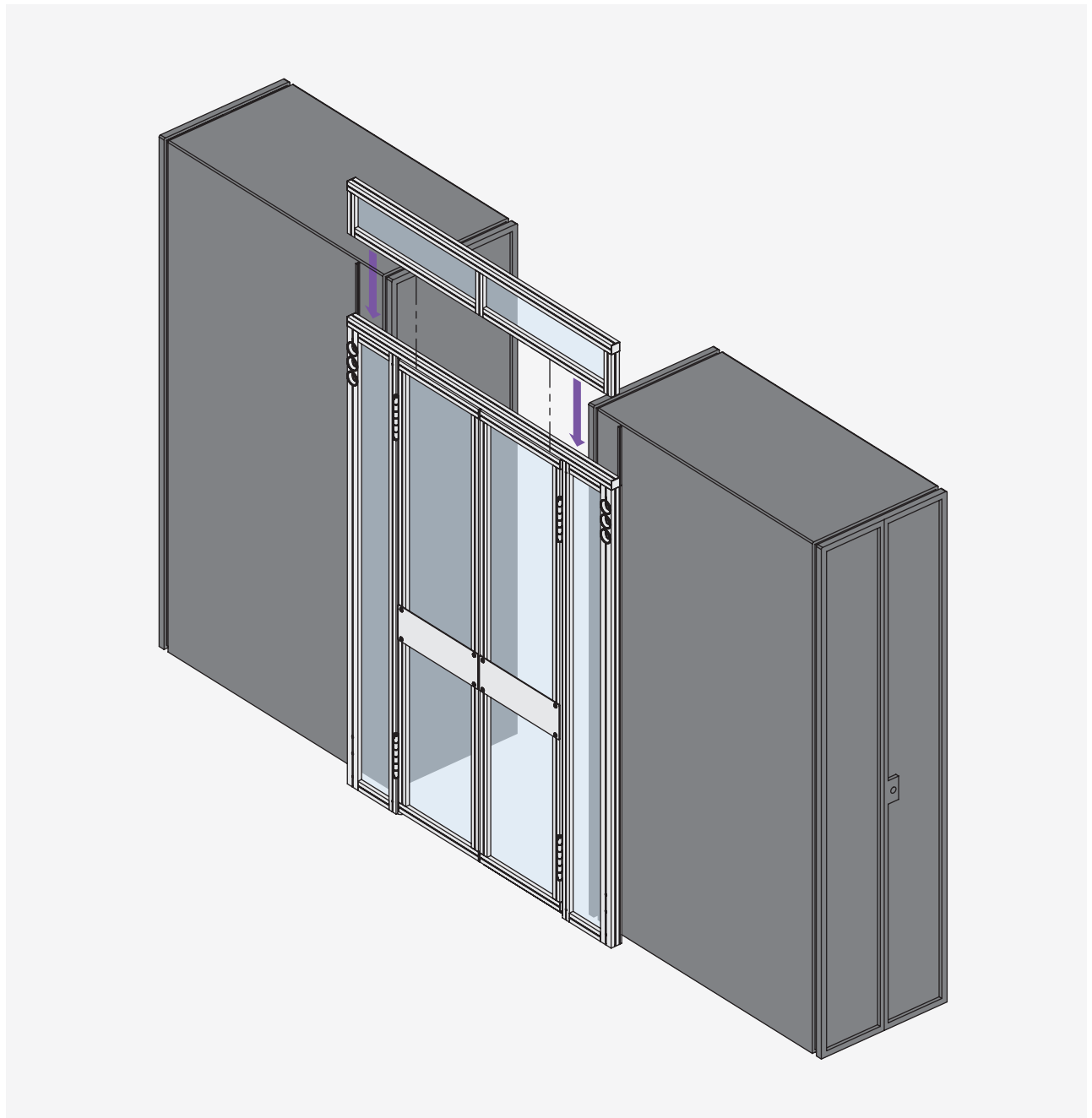

STEP 6

Install Tether and Cablelock:

6.1 Place the head of the Hammerhead Screw in the system groove on the side or top of the Header or Transom. Place the eyelet of the cable and washer over the Hammerhead Screw and secure with the Thumb Nut. Do not fully tighten the Thumb Screw at this point (Detail 6).

6.2 Pull the end of the Tether Cable over the top of the cabinet and loop through a secure location (Detail 7). Once the Tether Cable is looped through a secure location, push the end of the Tether Cable through the cable lock in the opposite direction, and pull gently to remove all slack (Detail 8).

6.3 Tighten Thumb Nut on Hammerhead screw (Detail 9).

6.4 Repeat on the opposite side of the Door/Aisle.

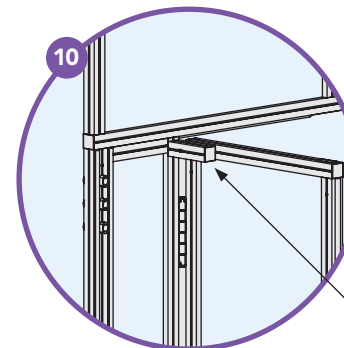
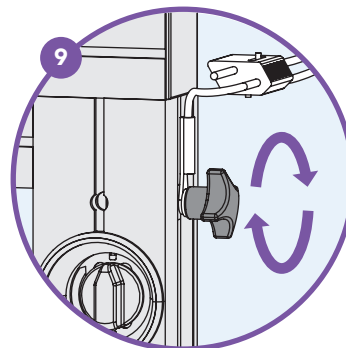
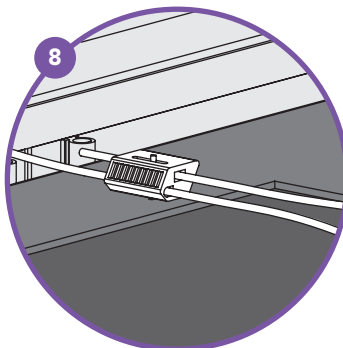
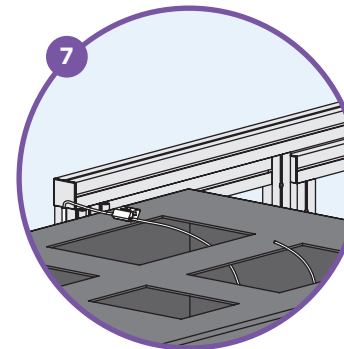
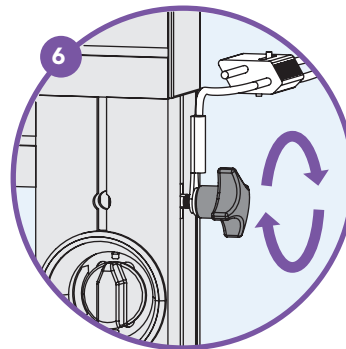
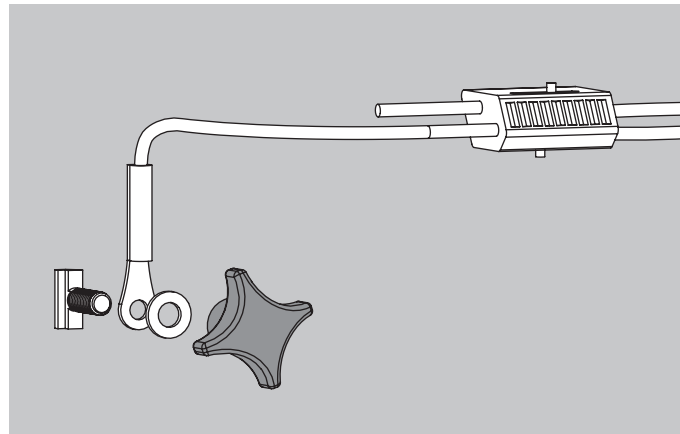

STEP 7

Doorstop/Stay Open Feature:

A Doorstop is pre-installed on the inside of each Door Panel. The Doorstop is used to keep the Door in the open position away from the aisle.

STEP 8

Door Opening Limiter Operation/Install (Optional):

8.1 To prevent the doors from opening into the aisle past 90 degrees an optional Door Opening Limiter is available. The door limiter may be needed when the IT Racks do not have doors protecting the IT equipment.

8.2 Door Opening Limiters are mounted to the inside surface of the Door Frame just above the Top Hinge (Detail 10). To secure the Door Opening Limiter, place the fingers of the CamLock in the system groove of the frame and tighten with the Torx Wrench.

Door Opening Limiter

FINISHED DOOR ASSEMBLY IMAGES

Congratulations, you have completed the installation of Magnetically Attached Double Swing Doors

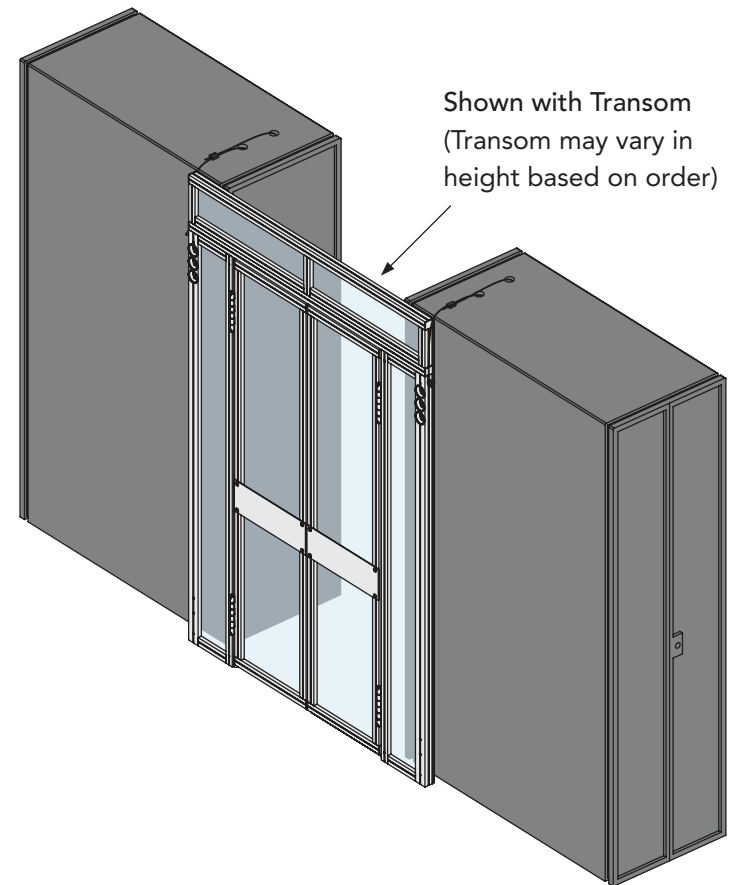
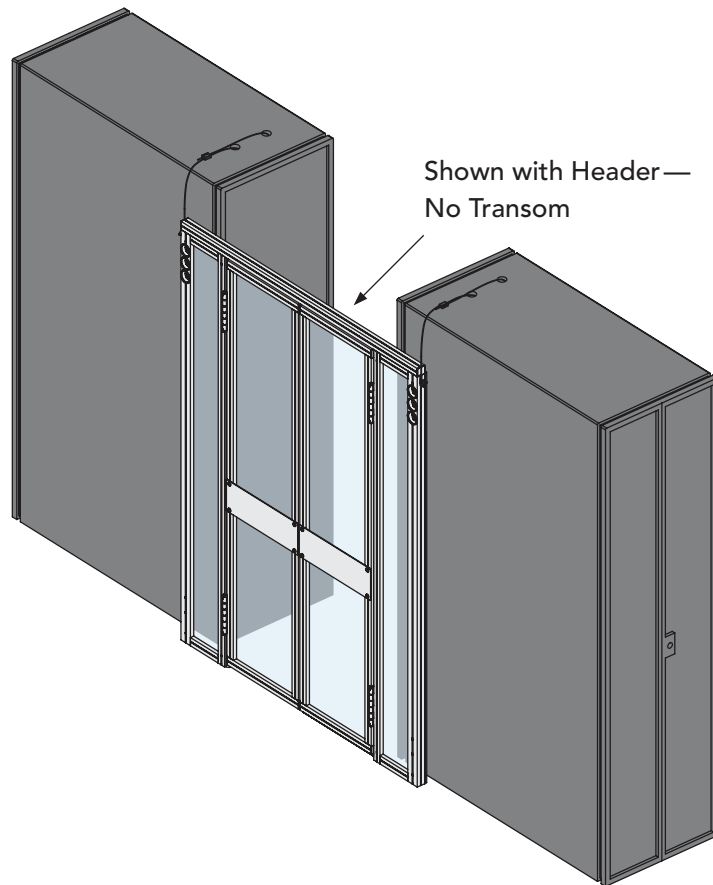

MOUNTING TO RETURN WALLS AND OTHER STRUCTURES

Magnetic Rigid Swing Doors can be attached to Upsite's other Rigid Containment products such as Chimneys, Ceilings, and Walls. These orders ship with metal Striker Plates included (Detail 11). When ordering doors that are not part of a full containment project, please order Upsite's Striker Plate Kit for attaching to other non-ferrous materials such as columns and sheetrock. PN.10164-SPK (2 per Pack)

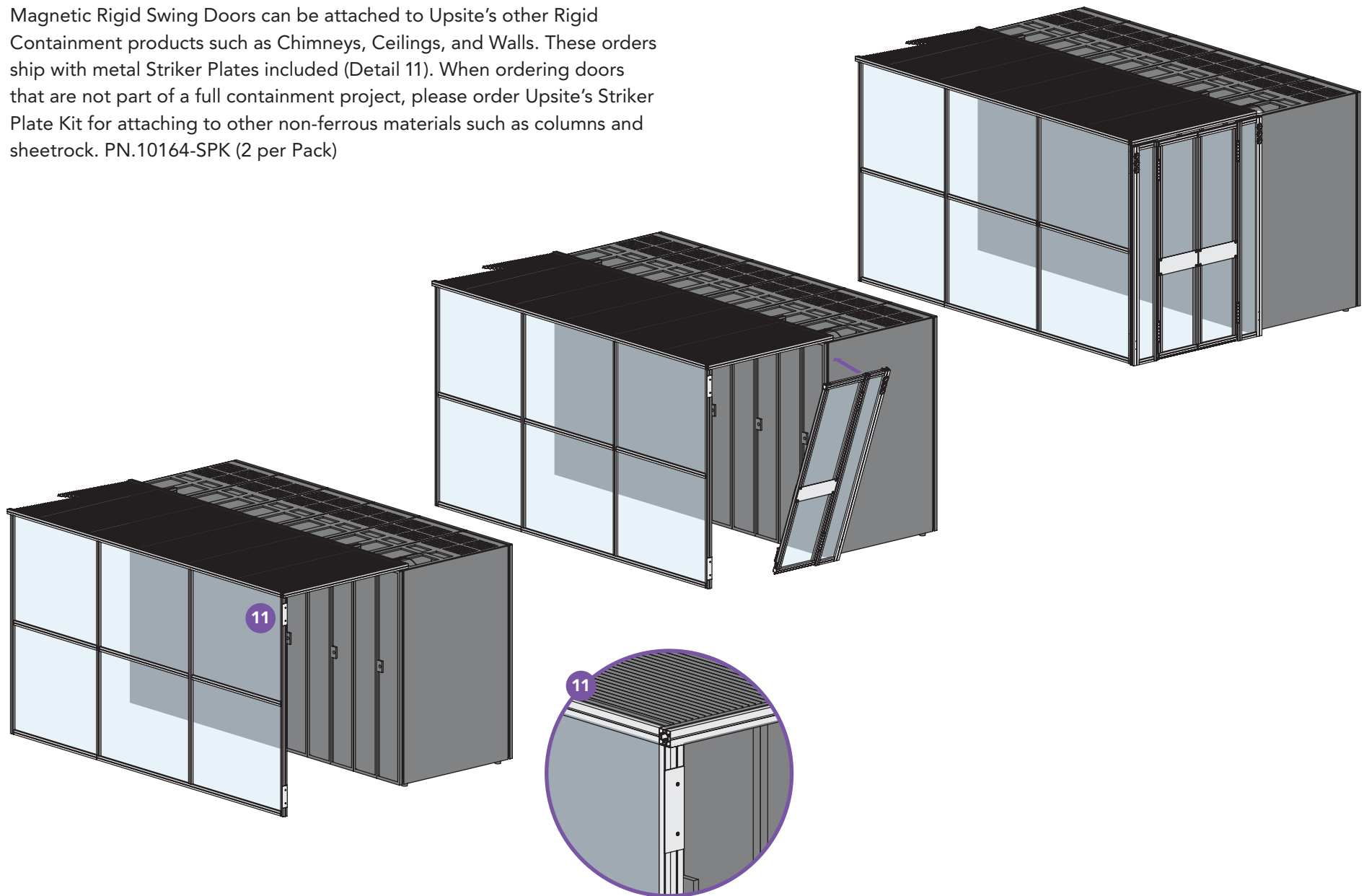

Dimensions

Door Size	A Door and Transom Width	B Sidelight Width	C Opened Door Width	D Opening Width	E Max Swing Distance	F Door Swing Radius	Min Aisle Width (frame to frame)	Max Aisle Width (frame to frame)
4'	1497 mm/58.9 in	277 mm/10.9 in	1854 mm/73 in	915 mm/36 in	525 mm/20.7 in	465 mm/18.3 in	1168 mm/46 in	1372 mm/54 in
5'	1795 mm/70.6 in	318 mm/12.5 in	2284 mm/89.9 in	1129 mm/44.5 in	632 mm/24.9 in	573 mm/22.5 in	1383 mm/54.4 in	1676 mm/66 in
6'	2100 mm/82.6 in	471 mm/18.5 in	2284 mm/89.9 in	1129 mm/44.5 in	632 mm/24.9 in	573 mm/22.5 in	1383 mm/54.4 in	1981 mm/78 in
7'	2405 mm/94.6 in	623 mm/24.5 in	2284 mm/89.9 in	1129 mm/44.5 in	632 mm/24.9 in	573 mm/22.5 in	1383 mm/54.4 in	2286 mm/90 in
8'	2709 mm/106.6 in	775 mm/30.5 in	2284 mm/89.9 in	1129 mm/44.5 in	632 mm/24.9 in	573 mm/22.5 in	1383 mm/54.4 in	2590 mm/102 in

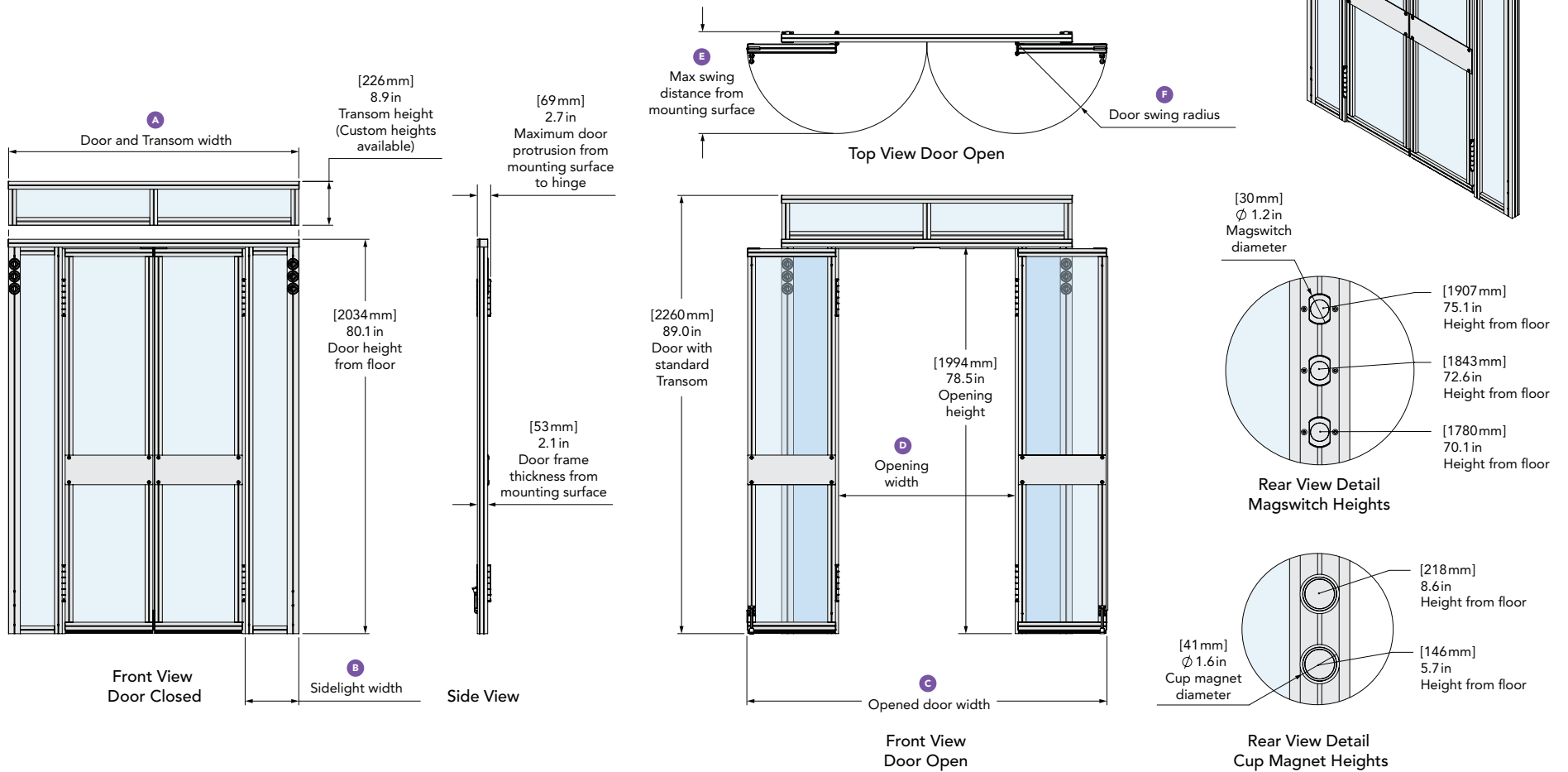

Troubleshooting

TS 1: GAP BETWEEN DOOR PANELS IS NOT EVEN

Two factors affect the gap between door panels; first, the position of the door panels on the Header, and second, the position of the post on the floor.

SOLUTION: The first step in aligning the gap between the Door Panel Assemblies is to adjust the gap at the top. This is done by adjusting the position of the Door Panel Assemblies on the Header. To do this, turn the Magswitchs to the unlocked position, and loosen the CamLoks. Adjust the Door Panel Assembly Position until the brush between the doors just touches. Tighten the CamLoks and turn Magswitchs to the locked position. Next, adjust the gap between the bottom of the Door Panel Assemblies by shifting the base of the Door Panel Assemblies on the cabinets, again so the brush just touches. See page 7 (gap between Door Panel Assemblies).

TS 2: TETHER CABLE-LOCK IS STUCK

The lock has been engaged with force.

SOLUTION: While applying pressure to the cable release tab, push the cable into the cable-lock in the opposite direction you are trying to move it, the cable-lock will then release.

TS 3: THE FACE OF DOOR PANELS ARE NOT ALIGNED AT THE BOTTOM, ONE IS MORE FORWARD

This is caused by the mounting surfaces not being parallel.

SOLUTION: If doors are mounted to cabinets then adjust leveling feet of the cabinets to bring the sides of the cabinets into the same plane. From outside the aisle looking at the doors, if the right-side door is more forward at the bottom, then use the leveling feet to tilt the cabinet on the right toward you. If the door on the right is further back at the bottom, then tilt the cabinet on the right, away from you. See page 1.

TS 4: DOORS DO NOT CLOSE ALL THE WAY

If the doors are not flush with the frame in the closed position, then the most likely cause is too much interference between the Magnetic Latches.

SOLUTION: Adjust the position of the Door Panel Assemblies as described in TS 1 above. Additionally, hinge tension may also be a factor, see TS 5 on the next page.

Troubleshooting

TS 5: ADJUSTING THE HINGE SPRING TENSION

Your doors arrive with the springs pre-tensioned by the factory. However, if you want to adjust the spring tension, it can be done by adjusting the position of the hinge spring retention pin. To do this, insert the provided hex key in the open end of the hinge barrel and apply sufficient pressure, in the direction that feels "springy," to remove tension from the retention pin (Detail 12). The location of the open end and the direction of rotation to remove tension varies depending on the hinge location. Once tension is released, the retention pin can be removed (Detail 13). Now rotate the hex key until the next retention pin hole is visible (Detail 14). Place the retention pin in the new location and remove the hex key (Detail 15).

TS 6: CONTACTING UPSITE ENGINEERING

If we haven't covered your issue, or you need additional assistance, please call Upsite Technologies at 1-888-982-7800 ext. 5.

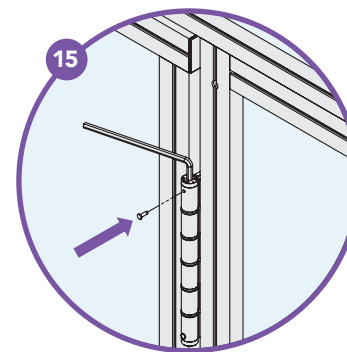
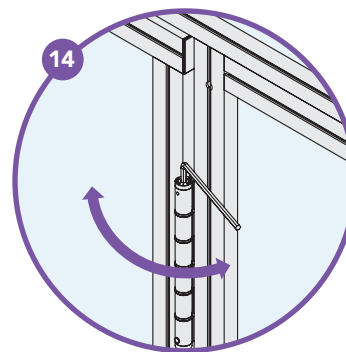
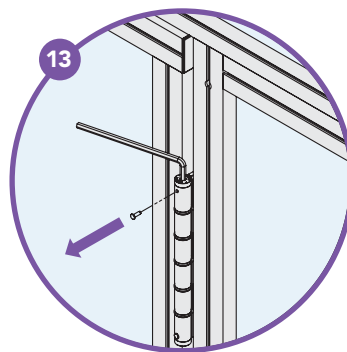
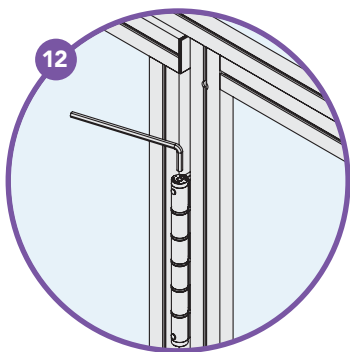
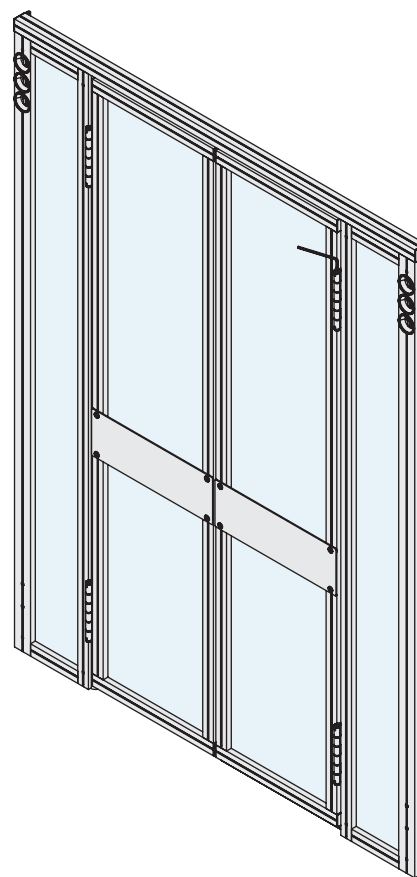

Limited Warranty

Upsite Technologies, Inc. (the Company) warrants to the original purchaser that products delivered hereunder will be free of defects in materials and workmanship for a period of twelve (12) months from the date of purchase (the "Warranty Period").

The Company shall, at its option, within the Warranty Period, either repair or replace free of charge, any product or part thereof found, upon the Company's inspection, to be defective in materials and workmanship, and will return the repaired or replaced product to the purchaser at Company's expense.

For warranty service and shipping instructions, contact the Company at the telephone number shown below. If the product is under warranty and the defect appears to be covered by this Limited Warranty, the Company will issue to the purchaser a Notice of Authorization For Warranty Return. Products returned to the Company for warranty service must be accompanied by a statement of defect, the Notice of Authorization for Warranty Return provided by the Company, and proof of purchase.

This Limited Warranty is conditioned on the following:

The Company must be notified within 12 months of purchase and have been given the opportunity of inspection by return of any alleged defective product free and clear of all liens and encumbrances to the Company or its manufacturer; and

The product must not have been abused, misused, or improperly maintained, and/or non-Upsite authorized repair performed during such period; and

Such defect has not been caused by corrosion or exposure to other than ordinary wear and tear; and

The installation and use of the product has been in accordance with the manufacturer's instructions and not been modified or customized to include but not limited to cut, resized, burned, glued, bent, re-shaped, disassembled, attachments added to, improperly installed or used in a manner other than intended.

The company makes no other express or implied warranty or representation of any kind whatsoever including any warranty of merchantability or fitness for a particular purpose and all such other warranties are hereby included.

The Company's maximum liability hereunder is limited to the purchase price of the product. In no event shall the Company be liable for any consequential, indirect, incidental, or special damages of any nature arising from the sale or use of the product, whether based in contract, tort, strict liability, or otherwise.

Note: Some jurisdictions do not allow limitations on incidental or consequential damages or how long an implied warranty lasts, so that the above limitations may not fully apply. This warranty gives specific legal rights and you may also have other rights which may vary from jurisdiction to jurisdiction.

For complete warranty and repair information Call 888.982.7800 or visit upsite.com

U.S. and International Patents Pending



KOLDLOK®

Raised Floor Airflow Management

HOTLOK®

Rack Airflow Management

AISLELOK®

Aisle Airflow Management

POWERLOK®

Rack Power Distribution

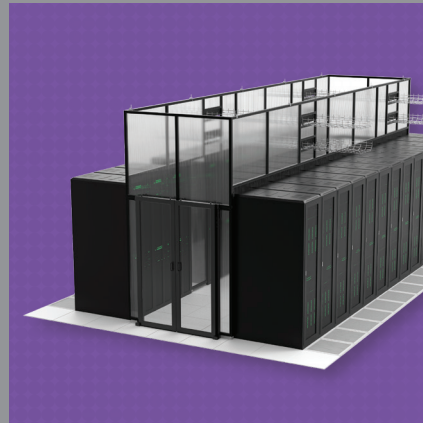
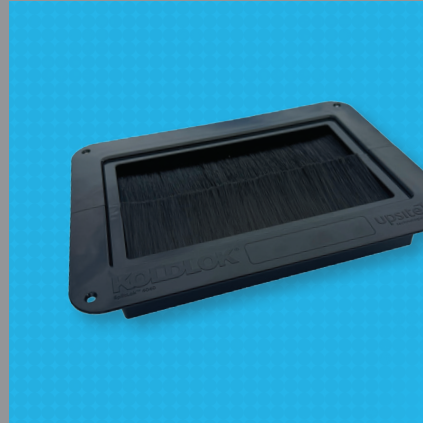



+1.888.982.7800 505.798.0200 info@upsite.com upsite.com